

P.C.B. LAYOUT

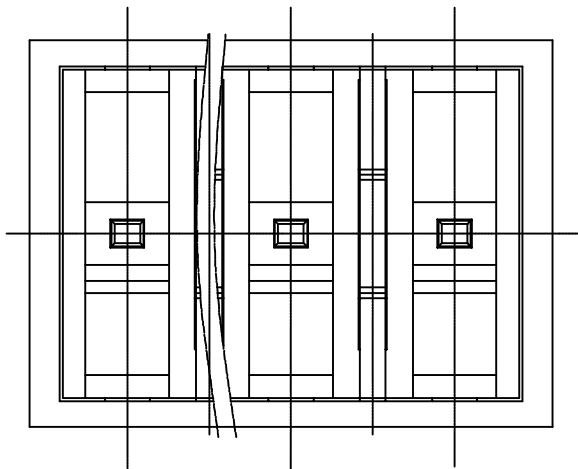
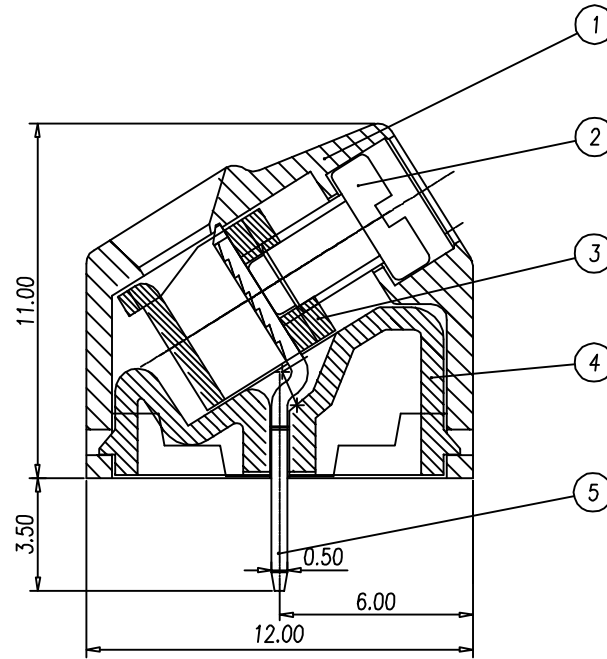

NOTES:

1. Rating: 300V 13.5A
PITCH: 5.00mm
2. Insulation Withstands Voltage:
AC 1500 V/MIN
3. Insulation Resistance:
500M Ω or more at DC500V
4. Using Temperature Range:
-40°C~+105°C
5. Screw Torque Value: $\frac{5 \text{ kgf-cm}}{4 \text{ kgf-cm}}$
6. Suitable Electric Wire: ~~26~14 AWG~~
30~14 AWG

7. Undimensioned Tolerances:

—	∩	∇	0.05/10
⊥	∥	≡	0.2/10
PITCH ERROR			0.05/10
UNDIMENSIONS TOLERANCES			±0.3

ITEM	NAME OF PART	NO. OF PART	Q'TY	MATERIAL	NOTES
5	SOLDER PIN	0100B00100	P	BRONZE	Tin plated
4	COVER	0100A3XX00	1	PA66(V0)	G001
3	WIRE CAGE	X000005400	P	STEEL	
2	SCREW	S000025300	P	STEEL	
1	HOUSING	0100A0XX00	1	PA66(V0)	G001

ITEM	NAME OF PART	NO. OF PART	Q'TY	MATERIAL	NOTES
DWG.	Z.Y	DATE	02,12,02	UNITS	MM SHEET/OF 1/2
CHK.		DATE		SCALE	6:1 (:)
APP.		DATE			

	產品更新	Y.y	04.11.03
		YFY	03.12.04
REV.	CONTENT	CHK.	DATE



NAME	ELK500A-□□
DWG NO.	SP-02-ELK500A0